

Vision Chain No.	P	b1	d2	d3	L3	L	Lc	d4
	mm	mm	mm	mm	mm	mm	mm	mm
10A-D9	15.875	9.40	5.08	6.35	20.0	39.5	41.1	
16AF1	25.400	15.88	7.92	9.0	20.0	51.2	54.7	
08B-D4	12.700	7.75	4.45	6.0	15.0	31.2	32.4	
08B-D7	12.700	7.75	4.45	6.0	14.0	30.2	31.4	2.6
08BF3	12.700	7.75	4.45	6.0	8.0	24.2	25.4	
10BF2	15.875	9.65	5.08	6.0	25.0	43.4	44.8	
10BF3	15.875	9.65	5.08	8.0	25.0	43.4	44.8	
10B-D7	15.875	9.65	5.08	6.5	40.0	58.5	60.1	
12B-D5	19.050	11.68	5.72	8.0	40.0	61.4	63.1	
12B-D6	19.050	11.68	5.72	6.0	20.0	41.1	42.9	
12B-D7	19.050	11.68	5.72	8.0	25.0	46.4	48.2	

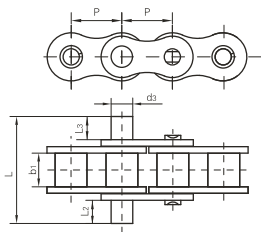

Vision Chain No.	P	b1	d3	L2	L3	L
	mm	mm	mm	mm	mm	mm
12A-D7	19.050	12.57	8.10	8.6	8.6	40.0
06B-D4	9.525	5.72	3.28	3.0	5.0	19.4
08B-D8	12.700	7.75	4.45	10.0	38.0	62.5
08BF7	12.700	7.75	4.45	3.0	5.0	22.8
16BF4	25.400	17.02	8.28	18.0	18.0	68.0

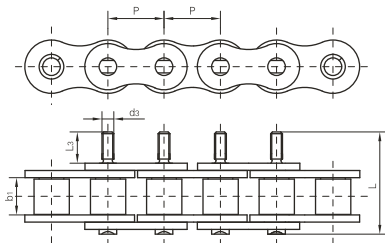

Vision Chain No.	$P$	$b_1$	$d_3$	$L_3$	$L$
	mm	mm	mm	mm	mm
12AF19	19.05	12.57	M4	10.0	34.5
12BF13	19.05	11.68	M4	10.0	31.0

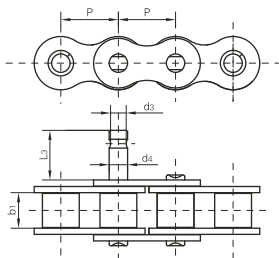

Vision Chain No.	$P$	$b_1$	$d_3$	$d_4$	$L_3$
	mm	mm	mm	mm	mm
10B-D9	15.875	9.65	4.5	5.08	13.0
10B-D12	15.875	9.65	4.5	5.08	12.0
12B-D8	19.05	11.68	5.15	5.72	13.0

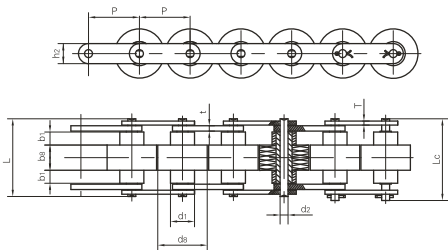

JB Chain No.	Vision Chain No.	Pitch p	Roller dimension				Pin diameter d <sub>2</sub>	Pin length		Plate dimension			Weight per meter q
			d <sub>1</sub> max	d <sub>3</sub> max	b <sub>1</sub> min	b <sub>3</sub> max		L max	L <sub>c</sub> max	h <sub>2</sub> max	T max	t max	
		mm	mm	mm	mm	mm	mm	mm	mm	mm	mm	mm	kg/m
BS25-C206B	C2030W	19.05	11.91	18.3	4.00	8.0	3.28	24.0	25.6	8.20	1.30	1.50	0.52
BS25-C208A	C2040W	25.40	15.88	24.6	5.70	10.3	3.96	31.0	32.8	11.70	1.50	1.50	0.79
BS25-C210A	C2050W	31.75	19.05	30.6	7.10	13.0	5.08	39.5	41.2	15.00	2.03	2.03	1.36
BS25-C212A	C2060HW	38.10	22.23	36.6	8.50	15.5	5.94	48.8	51.5	18.00	3.25	3.25	2.19
BS25-C216A	C2080W	50.80	28.58	49.0	11.00	21.5	7.92	66.2	70.0	24.00	4.00	5.00	4.06
BS30-C206B		19.05	9.00	18.3	4.50	9.1	3.28	26.3	29.6	7.28	1.30	1.50	0.50
BS30-C208A		25.40	11.91	24.6	6.10	12.5	3.96	35.6	39.5	9.60	1.50	2.00	0.83
BS30-C210A		31.75	14.80	30.6	7.50	15.0	5.08	43.0	47.1	12.20	2.00	2.40	1.27
BS30-C212A		38.10	18.00	37.0	9.75	20.0	5.94	58.1	62.7	15.00	3.00	4.00	2.14
BS30-C216A		50.80	22.23	49.0	12.00	25.2	7.92	71.9	77.3	18.60	4.00	5.00	3.55

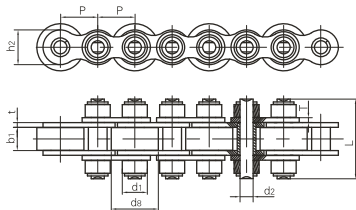

Vision Chain No.	Pitch	Roller diameter		Width between inner plates		Pin diameter	Pin length	Plate dimension		Ultimate tensile strength	Average tensile strength
	P	d <sub>1</sub> max	d <sub>s</sub> max	b <sub>1</sub> min	d <sub>2</sub> max	L max	h <sub>2</sub> max	t/T max	Q min	Q <sub>av</sub>	
	mm	mm	mm	mm	mm	mm	mm	mm	kN/LB	kN	
08BS-27-P16/C16	12.70	8.51	16.0	7.75	4.45	27.0	11.8	1.60/1.50	18.0/4091	19.8	
12BS-43-P26/C26	19.05	12.07	26.0	11.68	5.72	43.0	16.0	1.85	29.0/6591	31.7	
12BS-43-P28/C28	19.05	12.07	28.0	11.68	5.72	43.0	16.0	1.85	29.0/6591	31.7	
12BS-48-P24/C24	19.05	12.07	24.0	11.68	5.72	48.0	16.0	1.85	29.0/6591	31.7	
12BS-48-P26/C26	19.05	12.07	26.0	11.68	5.72	48.0	16.0	1.85	29.0/6591	31.7	
12BS-48-P28/C28	19.05	12.07	28.0	11.68	5.72	48.0	16.0	1.85	29.0/6591	31.7	
16BS-65-P38/C38	25.40	38.00	15.88	17.02	8.28	65.0	21.0	4.15/3.10	60.0/13636	72.8	

Note: P means roller made in plastic, C means roller made in steel.

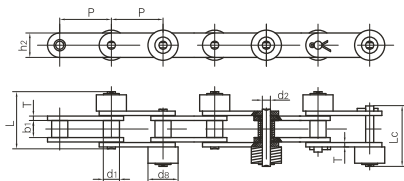

Vision Chain No.	Pitch	Roller diameter		Width between inner plates		Pin diameter		Pin length		Plate dimension		Ultimate tensile strength	Average tensile strength	Weight per meter
	P	d1 max	ds max	b1 min	d2 max	L max	Lc max	h2 max	T max	Q min	Qe	q		
	mm	mm	mm	mm	mm	mm	mm	mm	mm	kN/LB	kN	kg/m		
C2040S2-PSR	25.40	7.95	15.88	7.85	3.96	25.80	27.0	12.0	1.50	13.8/3137	15.18	0.99		
C2050S	31.75	10.16	19.05	9.40	5.08	31.80	34.0	15.0	2.03	21.8/4955	23.90	1.52		
C2052SF1	31.75	19.05	27.00	9.40	5.08	35.00	37.3	15.0	2.03	21.8/4955	23.90	3.06		
C2060HS	38.10	11.91	22.23	12.57	5.94	44.00	46.6	18.0	3.25	31.1/7069	42.70	1.78		

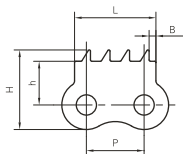

Vision Chain No.	P	h	H	B	L
	mm	mm	mm	mm	mm
08B-940	12.7	9.6	17.5	1.5	17.9

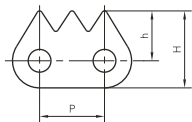

Vision Chain No.	P	h	H
	mm	mm	mm
08BF71	12.7	9.75	15.05

C16AF1 C16A-2ST

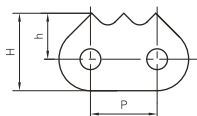

Vision Chain No.	P	h	H
	mm	mm	mm
C16AF1	25.4	17.5	29.5
C16AF2	25.4	17.5	29.5
C16A-2ST	25.4	17.4	29.0
C16A-5PEP	25.4	17.4	29.0
16A-1171	25.4	16.0	26.4

C16AF2 16A-5PEP 16A-1171

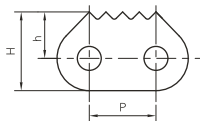

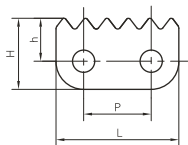

Vision Chain No.	P	L	h	H
	mm	mm	mm	mm
16B-1185	25.4	46.0	16.0	26.5

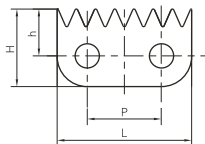

Vision Chain No.	P	h	H	L
	mm	mm	mm	mm
16B-1187	25.4	16.0	26.5	46

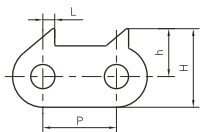

Vision Chain No.	P	h	H	L
	mm	mm	mm	mm
C16B-1160	25.4	10.5	27.5	4.8
C16B-1161	25.4	10.5	27.5	6.0

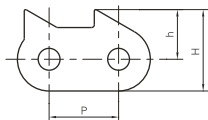

Vision Chain No.	P	h	H
	mm	mm	mm
C16A-1160	25.4	18	29.5

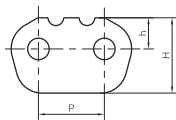

Vision Chain No.	P	h	H
	mm	mm	mm
16BF45	25.4	12.0	29.0

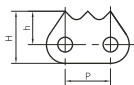

Vision Chain No.	P	h	H
	mm	mm	mm
C16BF3	25.4	18.7	29.2

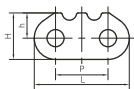

Vision Chain No.	P	L	h	H
	mm	mm	mm	mm
16B-1180	25.4	46.0	12.2	22.5

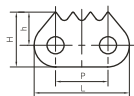

Vision Chain No.	P	L	h	H
	mm	mm	mm	mm
16B-1170	25.4	46.1	16.0	26.5
16B-1172	25.4	46.1	15	25.5



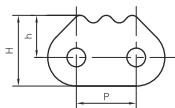

Vision Chain No.	P	h	H
	mm	mm	mm
C60F2	19.05	13.38	22.48

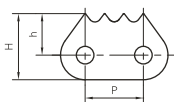

Vision Chain No.	P	h	H
	mm	mm	mm
12BF3	19.05	13.50	21.50

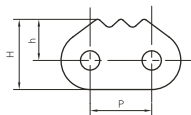

Vision Chain No.	P	h	H
	mm	mm	mm
60-910	19.05	12.70	21.70
12B-910	19.05	13.70	21.70

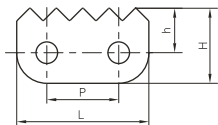

Vision Chain No.	P	h	H	L
	mm	mm	mm	mm
12B-911	19.05	11.9	20.0	35

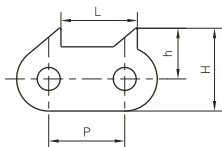

Vision Chain No.	P	h	H	L
	mm	mm	mm	mm
C12B-9010	19.05	13.0	21.0	19.05

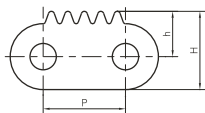

Vision Chain No.	P	h	H
	mm	mm	mm
LL1044F1	15.875	8.73	15.08

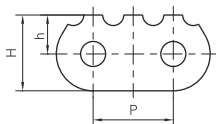

Vision Chain No.	P	h	H
	mm	mm	mm
60-911	19.05	9.25	18.0

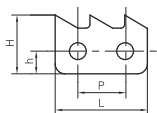

Vision Chain No.	P	L	h	H
	mm	mm	mm	mm
20AF1	31.75	57.2	14.75	35.84

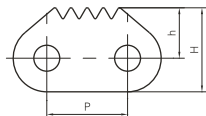

Vision Chain No.	P	h	H
	mm	mm	mm
C20BF9	31.75	19.8	33.0

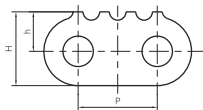
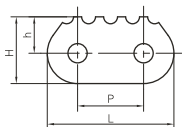

Vision Chain No.	P	L	h	H
	mm	mm	mm	mm
120-1802	38.1	73.1	21.0	38.5

Vision Chain No.	P	h	H
	mm	mm	mm
24B-1810	38.1	19	35.5

24B-1805

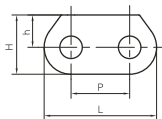

24B-1807

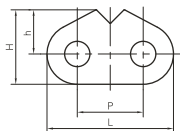

C24B-1820

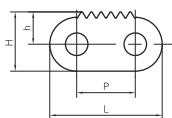

24B-1809

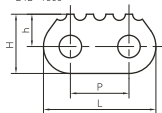

Vision Chain No.	P	L	h	H
	mm	mm	mm	mm
24B-1805	38.1	73.1	21.0	38.5
24B-1807	38.1	73.1	25.5	43.0
24B-1809	38.1	73.1	21.0	38.5
C24B-1820	38.1	73.1	21.0	38.5

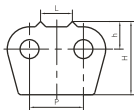

Vision Chain No.	P	h	H	L
	mm	mm	mm	mm
32BF4	50.8	26	70.0	30

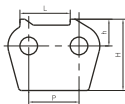

Vision Chain No.	P	h	H	L
	mm	mm	mm	mm
32B-1878	50.8	27	72	50.8

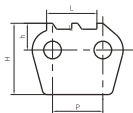

Vision Chain No.	P	h	H	L
	mm	mm	mm	mm
32B-1876	50.8	27	72.0	50.8

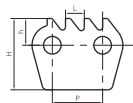

Vision Chain No.	P	h	H	L
	mm	mm	mm	mm
32B-1875	50.8	27	72.0	19

32B-1872

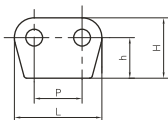

32B-1874

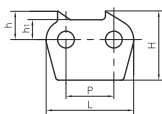

Vision Chain No.	P	L	h <sub>1</sub>	h	H
	mm	mm	mm	mm	mm
32B-1872	50.8	92.8		43.0	64.0
32B-1874	50.8	92.8	21.0	30.0	73.0

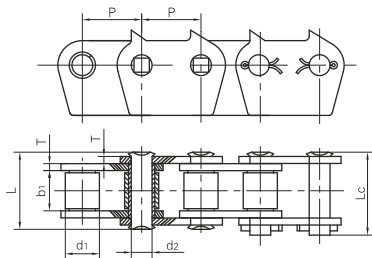

Vision Chain No.	Pitch	Roller diameter	Width between inner plates	Pin diameter	Pin length		Plate thickness	Ultimate tensile strength	Average tensile strength	Weight per meter
	p	d1 max	b1 min	d2 max	L max	Lc max	T max	Q min	Q <sub>0</sub>	q
	mm	mm	mm	mm	mm	mm	mm	kN/LB	kN	kg/m
32B-1-1872	50.8	29.21	33.0	17.81	66.0	71.0	6.0	250.0/56818	275.0	13.54

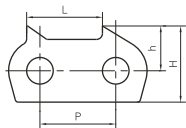

Vision Chain No.	P	h	H	L
	mm	mm	mm	mm
32B-1877	50.8	30	51	50.8

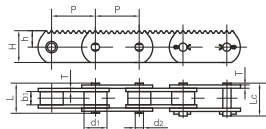

Vision Chain No.	P	h	H
	mm	mm	mm
P80	80.0	30	58

Vision Chain No.	Pitch	Roller diameter	Width between inner plates	Pin diameter	Pin length		Plate thickness	Ultimate tensile strength	Average tensile strength	Weight per meter
	P	d <sub>1</sub> max	b <sub>1</sub> min	d <sub>2</sub> max	L max	L <sub>c</sub> max	T max	Q min	Q <sub>0</sub>	q
	mm	mm	mm	mm	mm	mm	mm	kN/LB	kN	kg/m
P80	80.0	42.0	24.0	15.0	55.0	60.0	6.0	250.0/56818	275.0	11.3

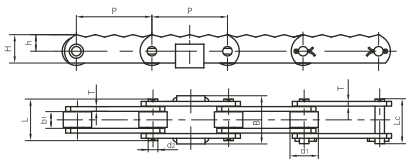

Vision Chain No.	P	h	H	B
	mm	mm	mm	mm
P80F2	80.0	17.5	30.0	51

Vision Chain No.	Pitch	Roller diameter	Width between inner plates	Pin diameter	Pin length		Plate thickness	Ultimate tensile strength	Average tensile strength	Weight per meter
	P	d <sub>1</sub> max	b <sub>1</sub> min	d <sub>2</sub> max	L max	L <sub>c</sub> max	T max	Q min	Q <sub>0</sub>	q
	mm	mm	mm	mm	mm	mm	mm	kN/LB	kN	kg/m
P80F2	80.0	30.0	18.0	10.0	44.6	48.3	5.0	61.74/14030	70.0	4.15

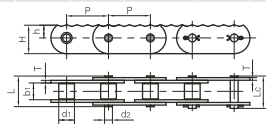

Vision Chain No.	P	h	H
	mm	mm	mm
P80F3	80.0	25	55

Vision Chain No.	Pitch	Roller diameter	Width between inner plates	Pin diameter	Pin length		Plate thickness	Ultimate tensile strength	Average tensile strength	Weight per meter
	P	d <sub>1</sub> max	b <sub>1</sub> min	d <sub>2</sub> max	L max	L <sub>c</sub> max	T max	Q min	Q <sub>0</sub>	q
	mm	mm	mm	mm	mm	mm	mm	kN/LB	kN	kg/m
P80F3	80.0	30.0	32.0	15.0	58.6	62.6	5.0	98.0/20909	107.0	9.12

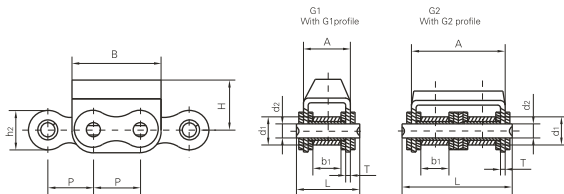

Vision Chain No.	Pitch	Roller diameter	Width between inner plates	Pin diameter	Pin length	Plate and attachment dimension					Ultimate tensile strength	Weight per meter
	P	d1 max	b1 min	d2 max	L max	h2 max	A	B	H	T	Q min	q
	mm	mm	mm	mm	mm	mm	mm	mm	mm	mm	kN/LB	kg/m
08B-G1	12.70	8.51	7.75	4.45	20.0	11.8	14.6	24.2	12.3	1.60	18.0/4091	1.19
08B-G2	12.70	8.51	7.75	4.45	34.3	11.8	28.4	24.2	12.3	1.50	32.0/7273	2.07
10B-G1	15.875	10.16	9.65	5.08	23.2	14.7	16.8	30.0	17.0	1.60	19.0/4318	1.62
10B-G2	15.875	10.16	9.65	5.08	39.7	14.7	33.3	30.0	17.0	1.50	44.5/10114	2.56
12B-G1	19.05	12.07	11.68	5.72	25.7	16.0	19.6	36.0	21.0	1.85	29.0/6591	2.01
12B-G2	19.05	12.07	11.68	5.72	45.3	16.0	39.1	36.0	16.0	1.85	57.8/13136	3.21
12A-G1	19.05	11.91	12.57	5.94	29.9	18.0	21.4	37.1	21.0	1.85	31.8/7153	2.55
12AF1-G1	19.05	11.91	17.00	5.94	34.0	18.0	26.0	36.0	16.0	1.85	31.8/7153	2.62
16A-G1	25.40	15.88	15.75	7.92	37.2	24.0	27.5	46.0	20.0	2.42	42.0/9545	3.97
16A-G2	25.40	15.88	15.75	7.92	68.0	24.0	57.2	46.0	20.0	2.42	84/18896	7.27
16B-G1	25.40	15.88	17.02	8.28	39.7	21.0	29.1	49.0	21.4	1.60	58.0/13047	3.83
20A-G1	31.75	19.05	18.90	9.53	46.8	30.0	34.0	57.6	28.0	3.10	86.7/19503	6.15
20B-G1	31.75	19.05	19.56	10.19	48.0	26.4	36.0	57.0	27.0	3.50	85.0/19318	6.19
24B-G1	38.10	25.40	25.40	14.63	61.6	33.2	47.0	72.6	34.0	4.50	160.0/36363	11.25

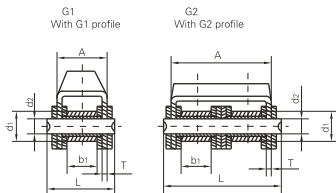
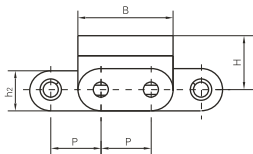

Vision Chain No.	Pitch	Roller diameter	Width between inner plates	Pin diameter	Pin length	Plate and attachment dimension					Ultimate tensile strength	Weight per meter
	P	d1 max	b1 min	d2 max	L max	h2 max	A	B	H	T	Q min	q
	mm	mm	mm	mm	mm	mm	mm	mm	mm	mm	kN/LB	kg/m
C08B-G1	12.700	8.51	7.75	4.45	20.0	11.8	14.6	24.2	12.3	1.60	18.0/4091	1.30
C08B-G2	12.700	8.51	7.75	4.45	34.3	11.8	28.4	24.2	12.3	1.50	32.0/7273	2.29
C10B-G1	15.875	10.16	9.65	5.08	23.2	14.7	16.8	30.0	17.0	1.60	19.0/4318	1.75
C10B-G2	15.875	10.16	9.65	5.08	39.7	14.7	33.3	30.0	17.0	1.50	44.5/10114	2.95
C12B-G1	19.050	12.07	11.68	5.72	25.7	16.0	19.6	36.0	21.0	1.85	29.0/6591	2.15
C12B-G2	19.050	12.07	11.68	5.72	45.3	16.0	39.1	36.0	16.0	1.85	57.8/13136	3.48
C16A-G1	25.400	15.88	15.75	7.92	37.2	24.0	27.5	46.0	20.0	2.42	42.0/9545	4.34
C16B-G1	25.400	15.88	17.02	8.28	39.7	21.0	29.05	49.0	21.4	1.60	58.0/13047	4.11
C20B-G1	31.750	19.05	19.56	10.19	48.0	26.4	36.0	57.0	27.0	3.50	85.0/19318	6.65
C24B-G1	38.100	25.40	25.40	14.63	61.6	33.2	47.0	72.6	34.0	4.50	160.0/36363	11.63



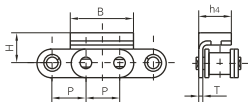

Vision Chain No.	P	B	H	h <sub>4</sub>	T
	mm	mm	mm	mm	mm
06BF9	9.525	17.73	9.0	9.05	1.3

Vision Chain No.	P	A	B	H	T
	mm	mm	mm	mm	mm
08B-G1F1	12.7	18.0	24.2	12.3	1.6
08B-G2F1	12.7	28.4	24.2	12.0	1.5

08B-G2F1

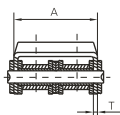

Vision Chain No.	P	A	B	H	T
	mm	mm	mm	mm	mm
10B-G1F2	15.875	25.0	30.0	14.0	1.6
10B-G1F3	15.875	20.0	30.0	18.0	1.6

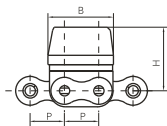
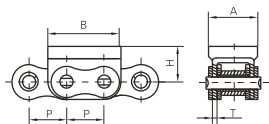

Vision Chain No.	P	A	B	H	T
	mm	mm	mm	mm	mm
12B-G2F3	19.05	77.0	37.0	36.0	1.85
12B-G2F8	19.05	101.0	37.0	36.0	1.85

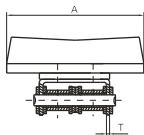

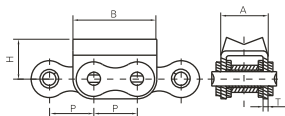

Vision Chain No.	P	A	B	H	T
	mm	mm	mm	mm	mm
12B-G1F1	19.05	19.6	36.0	18.0	1.85

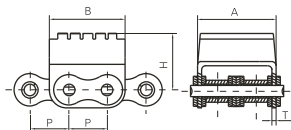

Vision Chain No.	P	A	B	H	T
	mm	mm	mm	mm	mm
12B-G2F6	19.05	39.1	37.3	28.2	1.85

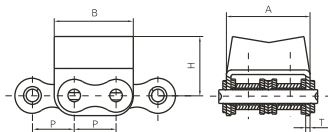

Vision Chain No.	P	A	B	H	T
	mm	mm	mm	mm	mm
12B-G2F4	19.05	39.1	36.0	27.5	1.85

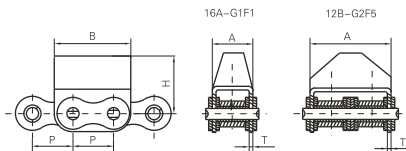

Vision Chain No.	P	A	B	H	T
	mm	mm	mm	mm	mm
12B-G2F5	19.05	39.1	36.0	28.0	1.85
16A-G1F1	25.40	27.5	46.0	21.4	2.42

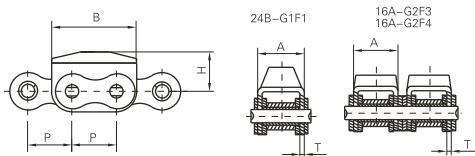

Vision Chain No.	P	A	B	H	T
	mm	mm	mm	mm	mm
16A-G2F3	25.4	27.5	49.0	21.4	2.42
16A-G2F4	25.4	27.0	49.2	20.0	2.03
24B-G1F1	38.1	47.0	72.6	34.0	4.5

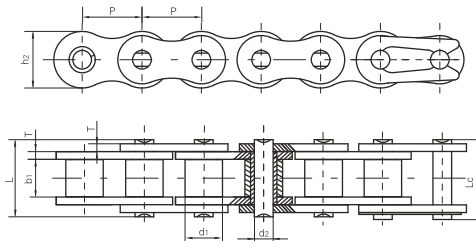

Vision Chain No.	Pitch	Roller diameter	Width between inner plates	Pin diameter	Pin length		Inner plate depth	Plate thickness	Ultimate tensile strength	Average tensile strength	Weight per meter
	P	d1 max	b1 min	d2 max	L max	Lc max	h2 max	T	Q min	Q0	q
	mm	mm	mm	mm	mm	mm	mm	mm	kN/LB	kN	kg/m
40-P	12.700	7.95	7.85	3.96	16.60	17.80	12.00	1.50	14.10/3205	17.5	0.56
50-P	15.875	10.16	9.40	5.08	20.70	22.20	15.09	2.03	22.20/5045	29.4	0.96
60-P	19.050	11.91	12.57	5.94	25.90	27.70	18.00	2.42	31.80/7227	41.5	1.35
80-P	25.400	15.88	15.75	7.92	32.70	35.00	24.00	3.25	56.70/12886	69.4	2.26
A2050-P	31.750	10.16	9.40	5.08	20.70	22.20	15.00	2.03	22.2/5045	28.1	0.61

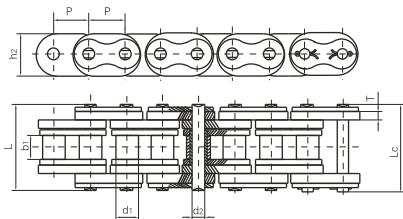

Vision Chain No.	Pitch	Roller diameter	Width between inner plates	Pin diameter	Pin length		Plate and attachment dimension		Ultimate tensile strength	Weight per meter
	P	d <sub>1</sub> max	b <sub>1</sub> min	d <sub>2</sub> max	L max	L <sub>c</sub> max	h <sub>2</sub>	T	Q min	q
	mm	mm	mm	mm	mm	mm	mm	mm	kN/LB	kg/m
16BF9	25.4	15.88	17.02	8.28	61.0	64.2	30.0	6.0	22.0/4949	3.7

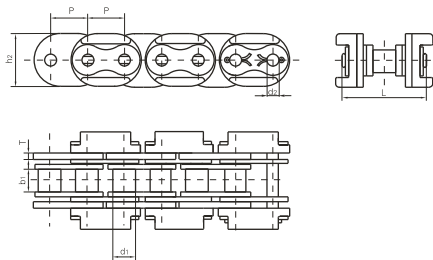

Vision Chain No.	Pitch	Roller diameter	Width between inner plates	Pin diameter	Pin length	Plate and attachment dimension		Ultimate tensile strength	Weight per meter
	P	d <sub>1</sub> max	b <sub>1</sub> min	d <sub>2</sub> max	L max	h <sub>2</sub> max	T	Q min	q
	mm	mm	mm	mm	mm	mm	mm	kN/LB	kg/m
20BF6	31.75	19.05	19.56	10.19	73.7	45.0	6.0	95.0/21591	6.35

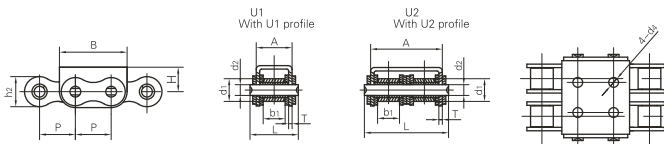

Vision Chain No.	Pitch	Roller diameter	Width between inner plates	Pin diameter	Pin length	Plate and attachment dimension						Ultimate tensile strength	Weight per meter
	P	d1 max	b1 min	d2 max	L max	h2 max	A	B	H	d1	T	Q min	q
	mm	mm	mm	mm	mm	mm	mm	mm	mm	mm	mm	kN/LB	kg/m
08B-U1	12.700	8.51	7.75	4.45	20.0	11.8	14.60	24.2	8.3	4	1.60	18.0/4091	1.13
08B-U2	12.700	8.51	7.75	4.45	34.3	11.8	28.40	24.2	8.3	4	1.50	32.0/7273	1.96
10B-U1	15.875	10.16	9.65	5.08	23.2	14.7	16.80	30.0	11.3	5	1.60	19.0/4318	1.53
10B-U2	15.875	10.16	9.65	5.08	39.7	14.7	33.30	30.0	11.3	5	1.50	44.5/10114	2.47
12B-U1	19.050	12.07	11.68	5.72	25.7	16.0	19.60	36.0	13.0	5	1.85	29.0/6591	1.90
12B-U2	19.050	12.07	11.68	5.72	45.3	16.0	39.10	36.0	12.0	5	1.85	57.8/13136	3.03
16A-U1	25.400	15.88	15.75	7.92	37.2	24.0	27.50	46.0	16.0	7	2.42	42.0/9545	3.87
16B-U1	25.400	15.88	17.02	8.28	39.7	21.0	29.05	49.0	15.4	6	1.60	58.0/13407	3.73
16B-U2	25.400	15.88	17.02	8.28	71.7	21.0	60.93	49.0	16.2	6	1.60	106/26094	6.15
20BF2	31.750	19.05	19.56	10.19	48.0	26.4	36.00	57.0	21.0	8	3.50	85.0/19318	6.01
24B-U1	38.100	25.40	25.40	14.63	61.6	33.2	47.00	72.6	28.0	10	4.50	160.0/36363	10.88

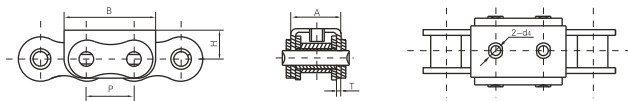

Vision Chain No.	P	A	B	d1	H	T
	mm	mm	mm	mm	mm	mm
10B-U1F1	15.875	16.8	30.0	M5	11.30	1.6
16A-U1F2	25.400	27.3	49.5	M6	16.45	2.3
16B-U1F3	25.400	30.3	49.5	M6	16.45	2.3
16B-U1F4	25.400	29.8	47.8	M5	15.00	2.0
16A-U1F7	25.400	27.3	49.5	M6	16.45	2.3

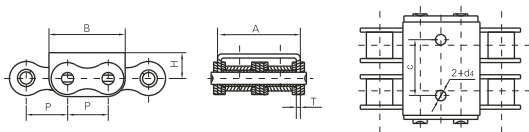

Vision Chain No.	P	A	B	C	d <sub>4</sub>	H	T
	mm	mm	mm	mm	mm	mm	mm
08B-U2F2	12.7	28.4	24.2	17.5	3.3	8.3	1.5

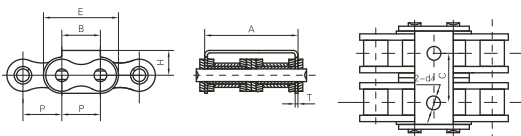

Vision Chain No.	P	A	B	C	d <sub>4</sub>	E	H	T
	mm	mm	mm	mm	mm	mm	mm	mm
16B-U2F1	25.4	60.93	25.0	33.5	9.0	49.0	16.2	1.6

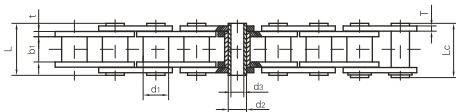

Vision Chain No.	Pitch	Bush diameter	Width between inner plates	Pin diameter		Pin length		Inner plate depth	Plate thickness	Ultimate tensile strength	Average tensile strength	Weight per meter
	P	d1 max	b1 min	d2 max	d3 min	L max	Lc max	h2 max	t/T max	Q min	Q0	q
	mm	mm	mm	mm	mm	mm	mm	mm	mm	kN/LB	kN	kg/m
08BHPF	12.700	8.51	7.75	6.55	4.50	16.4	17.6	11.80	1.6/1.3	11.1/2523	12.1	0.56
08BHPP5	12.700	8.51	7.75	6.30	4.50	16.8	18.0	12.00	1.60	9.6/2182	10.6	0.62
10BHPF3	15.875	10.16	9.65	7.02	5.13	19.5	20.5	14.70	1.70	10.0/2272	11.5	0.86
10BHPP4	15.875	10.16	9.65	7.20	5.00	19.8	21.3	14.00	2.03/1.6	12.5/2840	14.0	0.82
12BHPF2	19.050	12.07	11.68	8.09	6.00	22.7	23.9	16.10	1.85	14.0/3180	16.0	0.82
12BHPP3	19.050	12.07	11.70	8.22	5.75	23.6	24.9	16.20	2.42/1.85	16.0/3636	18.0	1.14
16BHPF3	25.400	15.88	17.02	11.50	8.20	35.3	37.0	23.20	4.0/3.1	49.0/11136	52.2	2.26
16BHPP4	25.400	11.70	13.50	8.00	4.30	28.9	30.2	21.30	3.00	30.0/6818	33.0	1.81
40HP	12.700	7.95	7.85	5.63	4.00	16.5	17.6	12.00	1.50	11.0/2500	12.2	0.54
50HP	15.875	10.16	9.40	7.03	5.13	20.7	21.9	15.09	2.03	20.0/4545	22.6	0.91
50HPP4	15.875	10.16	8.80	7.03	5.13	19.9	21.1	15.09	2.03	18.0/4180	19.2	0.89
60HP	19.050	11.91	12.70	8.31	6.00	25.8	26.8	18.00	2.42	24.0/5455	26.9	1.29
60HPP1	19.050	11.91	12.70	8.31	5.01	25.5	26.8	18.00	2.42	28.0/6364	30.9	1.37
80HP	25.400	15.88	15.75	11.40	8.05	32.5	33.8	24.00	3.25	50.0/11364	52.0	2.26
80HPP1	25.400	11.70	13.50	7.80	4.00	27.0	28.4	21.50	2.42	27.44/6236	29.3	1.50
80HPP2	25.400	15.88	15.75	11.40	8.40	32.5	33.8	24.00	3.25	45.0/10227	48.0	2.23
A2080HP	50.800	15.88	15.75	11.40	8.05	32.4	33.8	24.00	3.25	42.3/9615	46.1	1.60



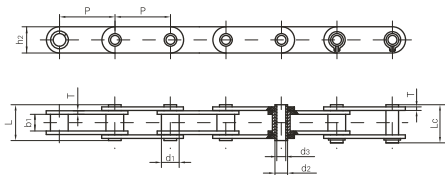

Vision Chain No.	Pitch	Bush diameter		Width between inner plates		Pin diameter		Pin length		Inner plate depth	Plate thickness	Ultimate tensile strength	Average tensile strength	Weight per meter
	P	d1 max	b1 min	d2 max	d3 min	L max	Lc max	h2 max	T	Q min	Q0	q		
	mm	mm	mm	mm	mm	mm	mm	mm	mm	kN/LB	kN	kg/m		
C2040HP	25.400	7.95	7.85	5.63	4.00	16.5	17.6	12.00	1.50	11.0/2500	12.6	0.46		
C2040HPF1	25.400	7.95	7.85	5.63	M4	16.5	17.6	12.0	1.5	9.0/2045	9.9	0.44		
C2050HP	31.750	10.16	9.40	7.22	5.12	20.5	21.8	15.00	2.03	20.4/4636	22.8	0.76		
C2060HP	38.100	11.91	12.70	8.31	6.00	25.8	26.8	17.00	2.42	24.0/5455	27.1	1.02		
HP40F1	40.000	18.00	22.00	12.00	8.00	47.5	48.2	35.00	5.00	57.0/13049	63.8	5.38		
HP40F2	40.000	18.00	22.00	12.00	8.20	47.5	48.2	35.00	5.00	57.0/13049	63.0	5.37		
C2080HP	50.800	15.88	15.75	11.40	8.05	32.5	33.8	24.00	3.25	50.0/11364	52.0	1.81		
HP50F1	50.000	26.00	14.50	20.00	14.70	35.3	36.2	40.00	3.10	30.0/6818	33.6	3.98		
C40HP	12.700	7.95	7.85	5.63	4.00	16.5	17.6	12.00	1.50	11.0/2500	12.2	0.64		
C50HP	15.875	10.16	9.40	7.03	5.13	20.7	21.9	15.09	2.03	20.0/4545	22.6	1.05		
C60HP	19.050	11.91	12.70	8.31	6.00	25.8	26.8	18.00	2.42	24.0/5455	26.9	1.52		
C80HP	25.400	15.88	15.75	11.40	8.05	32.5	33.8	24.00	3.25	50.0/11364	52.0	2.63		
C08BHP	12.700	8.51	7.75	6.55	4.50	16.4	17.6	11.8	1.6/1.3	11.0/2500	11.5	0.62		
HP12.5	12.500	8.51	8.20	6.65	4.50	16.4	17.6	11.6	1.5/1.3	8.0/1819	8.8	0.61		
HP50F7	50.000	18.00	15.00	14.00	10.20	36.0	37.5	26.0	4.0	40/9091	43.2	2.56		
HP50F10	50.000	18.00	22.00	12.10	8.30	39.5	40.6	30.0	3.0	45/10227	48.0	2.73		
HB55	55.000	18.00	22.00	14.00	10.00	43.4	44.5	30.0	4.0	50/11364	52.0	3.31		
HB55F1	55.000	24.00	24.00	17.00	12.00	52.0	53.5	40.0	5.0	90/20455	100.0	6.34		
HB38.1F8	38.100	10.16	9.65	7.10	5.40	20.4		16.0	2.03	13/2954	14.3	0.67		

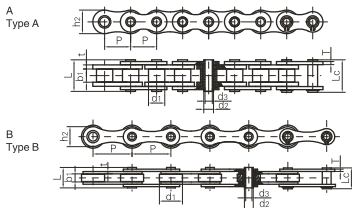

Vision Chain No.	Pitch	Roller diameter	Width between inner plates	Pin diameter			Pin length		Inner plate depth	Plate thickness	Ultimate tensile strength	Average tensile strength	Weight per meter	Type
	P	d1 max	b1 min	d2 max	d3 min	L max	Lc max	h2 max	t/T max	Q min	Q0	q		
	mm	mm	mm	mm	mm	mm	mm	mm	mm	kN/LB	kN	kg/m		
10BHB	15.875	10.16	9.65	5.94	4.04	19.30	20.6	14.70	1.70	17.00/3864	20.8	0.86	A	
12BHP	19.050	12.07	11.68	6.50	4.00	21.60	22.8	15.90	1.85	23.60/5364	25.9	1.09	A	
60HB	19.050	11.91	12.70	7.00	5.01	25.50	26.6	18.00	2.42	20.00/4545	22.4	1.35	A	
16BHBFB1	25.400	15.88	12.70	9.53	7.05	30.80	32.2	23.00	4.15/3.1	40.00/9091	45.0	2.28	A	
HB25.4	25.400	20.00	8.00	8.00	5.20	19.50	20.5	17.00	2.03	25.00/5680	28.0	1.30	A	
HP35	35.000	20.00	16.00	13.35	10.20	30.40	31.6	26.30	2.50	23.52/5345	26.4	2.02	A	
HB35	35.000	20.00	16.00	14.00	10.2	32.00	33.5	38.10	3.00	40.00/9091	45.0	2.39	A	
HB38.1	38.100	20.00	8.00	8.00	5.30	19.60	20.7	17.30	2.03	28.00/5682	28.8	0.98	B	
HB38.1F1	38.100	20.00	18.00	10.50	5.10	39.00	40.3	22.00	4.00	60.00/13636	64.3	2.59	B	
HB38.1F3	38.100	25.40	12.70	12.00	8.30	27.00	28.6	38.10	2.50	25.00/5682	28.8	1.51	B	
HB38.1F4	38.100	20.00	12.70	8.00	5.20	26.00	27.2	17.00	2.42	24.00/5455	26.9	1.48	B	
HP40F4	40.000	26.00	10.00	11.40	8.20	26.50	28.0	24.00	3.00	50.00/11364	56.7	2.20	B	
HP41.75F1	41.750	17.10	20.20	11.11	8.20	35.70	39.0	21.65	3.10	26.50/6022	29.2	1.60	A	
HP41.75F2	41.750	17.10	20.20	11.11	8.20	35.70	41.0	25.26	3.10	49.00/11136	54.8	2.04	A	
HP41.75F3	41.750	17.00	20.50	11.00	8.30	36.00	39.5	21.40	3.00	27.00/6136	28.0	1.62	A	
HP50F2	50.000	31.00	15.00	13.20	10.20	36.50	38.0	25.00	4.00	40.00/9091	43.2	3.40	B	
HB50	50.000	30.00	10.50	11.40	8.20	27.40	28.6	26.00	3.10	50.00/11364	53.6	2.23	B	
HB50.8	50.800	30.00	10.50	11.40	8.20	27.40	28.6	26.00	3.10	50.00/11364	53.6	2.56	B	
HB50.8F4	50.800	30.00	10.50	13.60	8.20	27.40	28.9	26.00	3.10	42.00/9545	48.2	2.28	B	
HB63	63.000	30.00	10.00	11.40	8.10	26.70	28.1	26.50	3.10	50.00/11364	53.6	2.07	B	
HB63F1	63.000	40.00	10.00	11.40	8.10	26.70	28.1	26.50	3.10	50.00/11364	53.6	2.27	B	
HB63F2	63.000	40.00	20.00	11.40	8.10	36.70	38.1	26.50	3.10	50.00/11364	53.6	3.20	B	
HB63F3	63.000	40.00	15.00	11.40	8.20	35.60	37.0	26.50	4.00	35.00/7955	38.5	3.90	B	
HB63F4	63.000	30.00	20.00	11.40	8.10	27.40	36.7	38.10	3.10	50.00/11364	53.6	2.97	B	
HB63F6	63.000	30.00	10.00	11.70	8.20	26.70	28.1	26.50	3.10	50.00/11364	56.7	2.08	B	
HB63F7	63.000	40.00	18.00	14.00	10.20	38.00	39.5	28.00	4.00	50.00/11364	56.7	4.26	B	
HB63F8	63.000	30.00	20.00	11.70	8.10	36.50	38.0	26.50	3.10	50.00/11364	56.7	2.91	B	
HB100	100.000	30.00	10.50	11.40	8.20	27.40	28.6	26.00	3.10	50.00/11364	53.6	1.56	B	

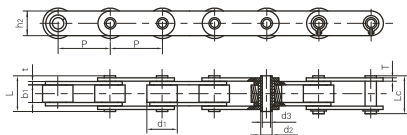

Vision Chain No.	Pitch	Roller diameter	Width between inner plates		Pin diameter			Pin length		Inner plate depth	Plate thickness	Ultimate tensile strength	Average tensile strength	Weight per meter
	P mm	d1 max mm	b1 min mm	d2 max mm	d3 min mm	L max mm	Lc max mm	h2 max mm	t/T max mm	Q min kN/LB	Q0 kN	q kg/m		
C2042HP	25.40	15.88	7.85	5.63	4.00	16.5	17.6	12.00	1.50	11.0/2500	12.6	0.78		
C2052HP	31.75	19.05	9.53	7.22	5.12	20.5	21.8	15.00	2.03	20.4/4636	22.8	1.25		
C2062HP	38.10	22.23	12.70	8.31	6.00	25.8	26.8	17.00	2.42	24.0/5455	27.1	1.72		
C2082HP	50.80	28.58	15.75	11.40	8.05	32.4	33.8	24.00	3.25	50.0/11364	52.0	2.82		
C2042H-HP	25.40	15.88	7.85	5.63	4.00	18.8	19.9	12.00	2.03	11.0/2500	13.2	0.95		
C2052HPF1	31.75	19.05	9.40	7.03	5.12	20.0	21.5	15.30	1.85	15.0/3409	17.3	1.21		
C2052HPF3	31.75	19.05	9.53	7.02	5.13	20.1	21.6	15.09	2.03	19.6/4455	21.6	1.20		
C2052H-HP	31.75	19.05	9.53	7.22	5.12	22.1	23.4	15.00	2.42	20.4/4545	23.5	1.44		
C2062H-HP	38.10	22.23	12.70	8.31	6.00	29.2	30.2	17.00	3.25	24.0/5455	27.6	1.99		
C2082H-HP	50.80	28.58	15.75	11.40	8.05	35.7	37.0	24.00	4.00	50.0/11364	56.5	3.34		
HP40	40.00	22.00	8.75	9.00	6.00	23.0	24.2	18.00	2.50	27.0/4545	28.0	1.49		
HB40F1	40.00	22.00	9.00	9.00	6.00	23.0	24.5	18.00	2.50	20.0/4546	22.0	1.58		
HB41.4	41.40	25.40	15.00	13.8	10.50	35.5	37.0	32.00	4.00	45.0/10227	48.0	4.20		
HP50	50.00	31.00	14.50	13.20	10.40	31.1	32.5	25.00	3.10	30.0/6818	34.2	3.29		
HP50F4	50.00	31.00	15.00	13.20	10.20	36.5	38.0	25.00	4.00	40.0/9091	44.8	3.73		
HB50	50.00	31.00	15.00	14.00	10.20	36.0	37.5	25.00	4.00	40.0/9091	43.2	3.98		
HB50.8F8	50.80	32.00	20.00	19.10	12.40	44.6	46.4	40.00	5.0/4.0	100.0/22727	108.0	6.75		
C1655HP	50.80	30.00	10.5	13.00	8.20	27.4	28.9	26.00	3.10	42.0/9545	48.2	2.72		
HP50.8	50.80	26.00	15.88	20.00	14.30	41.0	42.2	38.10	4.80	100.0/22727	108.0	5.32		
HB50.8F9	50.80	35.00	12.00	15.50	10.20	36.0	37.3	30.00	5.00	70.0/15909	77.0	4.92		
63HPF1	63.00	40.00	15.00	16.00	12.10	35.0	36.2	28.50	4.00	50.0/11364	56.7	4.20		
DH4202HP	50.80	31.80	15.00	14.00	10.10	36.3	39.0	26.00	3.80	42.0/9545	51.6	3.75		
DH4203HP	76.20	31.80	15.00	14.00	10.10	36.3	39.0	26.00	3.80	42.0/9545	47.1	3.01		
DH42035HP	88.90	31.80	15.00	14.00	10.10	36.3	39.0	26.00	3.80	42.0/9545	51.1	2.79		
DH4204HP	101.60	31.80	15.00	14.00	10.10	36.3	39.0	26.00	3.80	42.0/9545	51.6	2.63		
DH8403HP	76.20	47.60	19.00	19.05	13.60	43.8	46.3	39.00	5.1/3.8	84.3/19159	130.3	6.81		
DH8404HP	101.60	47.60	19.00	19.05	13.60	43.8	46.3	39.00	5.1/3.8	84.3/19159	130.3	5.78		

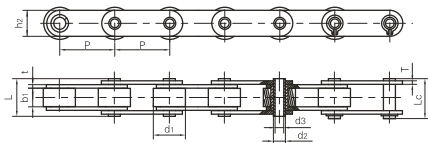

Vision Chain No.	Pitch	Roller diameter	Width between inner plates		Pin diameter		Pin length		Inner plate depth	Plate thickness	Ultimate tensile strength	Average tensile strength	Weight per meter
	P mm	d1 max mm	b1 min mm	d2 max mm	d3 min mm	L max mm	Lc max mm	h2 max mm	t/T max mm	Q min kN/LB	Q <sub>0</sub> kN	q kg/m	
DH8406HP	152.40	47.60	19.00	19.05	13.60	43.8	46.3	39.0	5.1/3.8	84.0/19091	130.3	5.18	
HB38.1F2	38.10	25.40	12.70	9.50	6.60	26.6	28.0	19.1	2.30	20.0/4545	22.4	2.07	
HB50.8F3	50.80	30.00	16.00	14.00	9.00	36.4	37.5	25.5	3.10	42.0/9545	47.0	3.20	
HB75	75.00	40.00	22.00	18.00	12.20	42.0	44.0	35.0	4.00	60.0/13636	72.0	5.57	
HB76.2	76.20	31.75	15.50	12.70	9.50	35.5	37.0	26.0	4.00	42.0/9545	49.2	3.25	
HB76.2F2	76.20	47.60	20.00	24.00	18.50	44.5	46.1	40.0	5.0/4.0	79.0/17953	92.5	6.77	
HB80	80.00	50.00	20.00	24.00	18.50	44.5	46.1	40.0	5.0/4.0	79.0/17953	92.5	6.81	
HP100	100.00	45.00	22.00	16.00	12.00	46.0	47.5	35.0	5.00	75.0/17044	90.0	6.20	
HP100F1	100.00	45.00	22.00	18.00	12.00	47.2	48.5	35.0	5.00	75.0/17044	90.0	6.15	
HP101.6F1	101.60	47.60	19.00	19.00	13.20	46.2	48.0	40.0	5.0/4.0	53.0/12045	58.2	6.09	
HP101.6F2	101.60	66.70	25.40	26.90	20.10	59.2	60.7	51.0	7.1/5.1	150.0/34088	160.0	14.23	
HP152	152.40	66.70	25.40	26.90	19.56	57.2	59.5	50.8	7.1/5.1	94.0/21362	107.8	9.90	
HP152.4F1	152.40	47.60	19.00	19.00	13.20	46.2	48.0	40.0	5.0/4.0	54.0/12270	59.5	5.00	

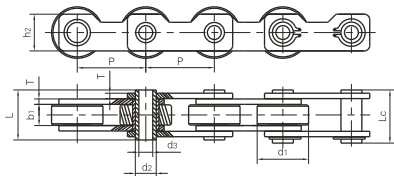

Vision Chain No.	Pitch	Roller diameter	Width between inner plates		Pin diameter		Pin length		Plate depth	Plate thickness	Ultimate tensile strength	Average tensile strength	Weight per meter
	P mm	d1 max mm	b1 min mm	d2 max mm	d3 min mm	L max mm	Lc max mm	h2 max mm	T mm	Q min kN/LB	Q <sub>0</sub> kN	q kg/m	
HB50.8F1	50.80	38.10	15.70	15.50	10.3	35.2	36.7	27.2	4.00	55.46/51650	58.8	4.97	



A  
Type A

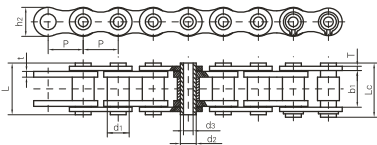

B  
Type B

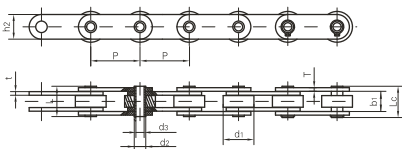

Vision Chain No.	Pitch	Roller diameter	Width between outer plates	Pin diameter			Pin length		Inner plate depth	Plate thickness	Ultimate tensile strength	Average tensile strength	Weight per meter	Type
	P	d1 max	b1 min	d2 max	d3 min	L max	Lc max	h2 max	t/T max	Q min	Q0	q		
	mm	mm	mm	mm	mm	mm	mm	mm	mm	kN/LB	kN	kg/m		
08BHPP2	12.700	8.51	13.20	6.65	5.20	18.0	19.2	11.8	1.6/1.3	10.00/2273	11.4	0.50	A	
08BHPP3	12.700	8.51	13.40	6.65	4.00	19.0	20.2	11.8	1.70	14.00/3182	16.8	0.69	A	
HB12.7	12.700	8.51	13.40	6.65	4.10	19.0	20.2	11.8	1.70	14.00/3182	16.8	0.69	A	
10BHPP1	15.875	10.16	13.41	7.03	5.00	19.2	20.2	14.0	1.85	17.00/3864	20.6	0.83	A	
10BHPP2	15.875	10.16	10.40	7.03	5.00	17.0	18.0	14.0	1.85	15.00/3409	17.3	0.74	A	
12BHPP1	19.050	12.07	16.00	8.03	5.40	22.7	23.9	15.8	1.85	25.00/5682	28.8	1.09	A	
16BHPP1	25.400	15.88	25.58	11.50	8.10	36.5	37.6	21.0	4.15/3.1	45.00/10227	52.2	2.21	A	
50HPP1	15.875	10.16	13.60	7.03	5.13	20.7	21.9	14.4	2.03	18.00/4091	21.6	0.92	A	
60HPP2	19.050	11.91	11.23	5.63	4.05	16.5	17.6	10.4	1.50	10.00/2273	10.8	0.62	A	
60HPP3	19.050	11.91	17.20	8.40	6.10	24.7	26.0	18.0	2.03	20.00/4546	24.0	1.54	A	
63HP	63.000	40.00	23.50	16.00	12.00	35.3	38.3	28.6	4.00	65.00/14773	71.5	4.14	B	
63HPP2	63.000	40.00	25.80	14.00	8.08	39.1	41.1	20.0	5.00	50.00/11364	65.7	4.17	B	
63HPP4	63.000	40.00	23.50	16.00	12.30	34.7	37.7	28.6	4.00	44.00/10000	57.2	4.13	B	
63HPP6	63.000	40.00	28.94	16.00	10.30	41.8	43.4	28.6	4.00	44.00/10000	57.2	5.18	B	
C2122HPP1	76.200	47.60	29.00	17.81	12.70	43.3	44.7	38.1	4.80	53.34/12123	59.2	7.05	B	

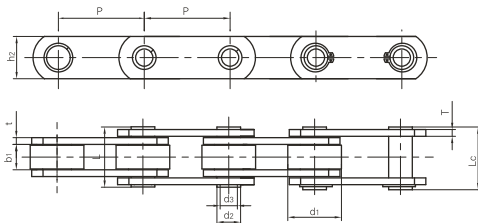

Vision Chain No.	Pitch	Roller diameter	Width between inner plates		Pin diameter			Pin length		Inner plate depth	Plate thickness	Ultimate tensile strength	Average tensile strength	Weight per meter
	P	d <sub>1</sub> max	b <sub>1</sub> min	d <sub>2</sub> max	d <sub>3</sub> min	L max	L <sub>c</sub> max	h <sub>2</sub> max	t/T max	Q min	Q <sub>0</sub>	q		
	mm	mm	mm	mm	mm	mm	mm	mm	mm	kN/LB	kN	kg/m		
MC56F1-S-80	80.00	30.00	24.00	16.00	10.20	45.5	47.0	35.0	4.0	56.0/12600	62.0	4.64		
MC56F2-P-100	100.00	50.00	23.00	16.00	10.20	45.5	47.0	35.0	4.0	56.0/12600	62.0	6.27		
MC112F1-P-100	100.00	70.00	32.00	22.00	16.30	67.0	68.5	50.0	6.0	112.0/25195	123.2	14.91		
MC150F2-P-110	110.00	66.70	25.40	26.90	20.20	58.0	60.5	51.0	7.1/5.1	106.7/24003	118.0	13.50		
FVC63F1-B-40	40.00	18.00	22.00	12.00	8.20	47.5	49.0	35.0	5.0	46.0/10348	51.0	5.34		
FVC63F2-B-50	50.00	17.00	22.00	12.00	8.20	41.0	42.0	25.0	3.0	30.0/6750	33.0	2.24		
FVC63F3-P-63	63.00	40.00	22.00	11.70	8.10	44.0	46.0	30.0	4.0	46.0/10348	51.0	5.83		
FVC90F1-P-63	63.00	42.00	25.00	14.00	10.20	52.0	53.5	35.0	5.0	73.0/16422	80.0	5.33		
FVC140F1-B-80	80.00	26.00	35.00	18.00	12.50	65.0	67.0	46.0	6.0	110.0/24745	120.0	7.80		